

SARS-CoV-2 Antibody Test (Lateral Flow Method)

 **The 1st officially approved antibody test in China!**

- Easy to use, no equipment required
- Multiple sample types, including fingerstick blood
- Instant result in 15 minutes
- Total antibody test, higher detection rate comparing with single IgG/IgM test
- CFDA and CE certified



Application

- ✓ Suspected case screening
- ✓ Help the exclusion of non-COVID-19 patients
- ✓ RT-PCR negative patients re-confirmation
- ✓ Identify asymptomatic patients
- ✓ Epidemiological tracing

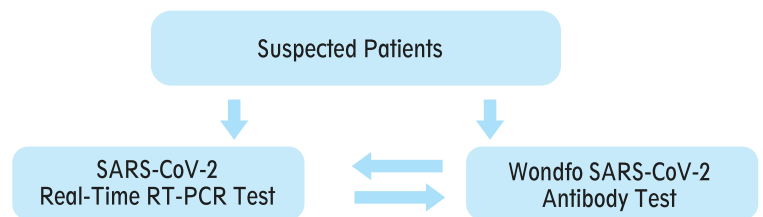

- Antibodies usually become detectable in the human blood 7 days later after disease onset, detection rate is higher after 10 days since disease onset.
- RT-PCR test should be confirmed in case of false positive/negative of antibody detection.
- Because of high false-negative rate of RT-PCR test, antibody test is recommended for re-confirmation.
- Suspected patients can be excluded from COVID-19 if two negative results for two consecutive RT-PCR tests of respiratory tract samples taken at least 24 hours apart and negative result for antibody test performed 7 days after disease onset.

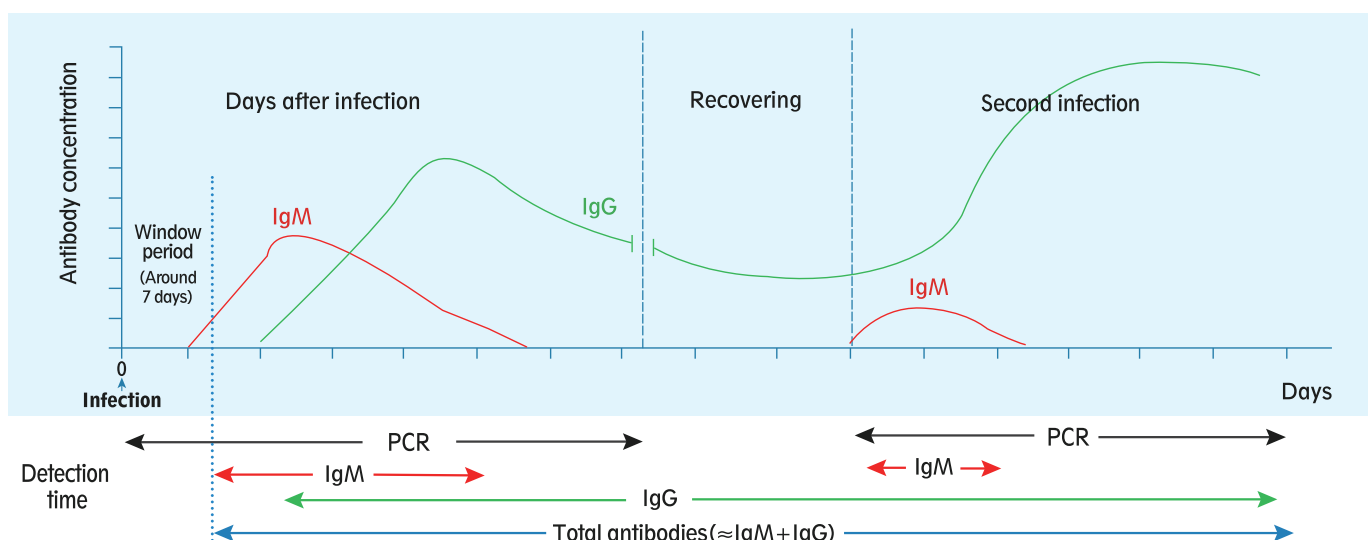

Operation procedure

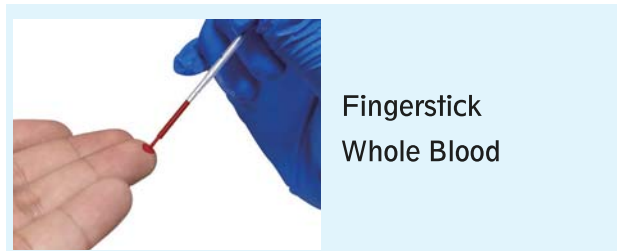

Fingerstick
Whole Blood

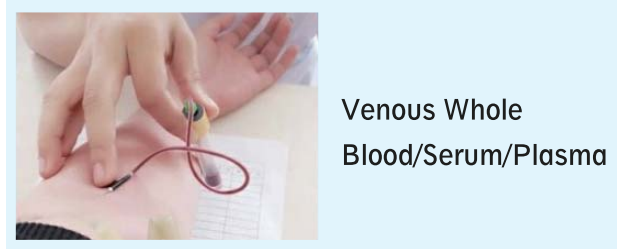

Venous Whole
Blood/Serum/Plasma

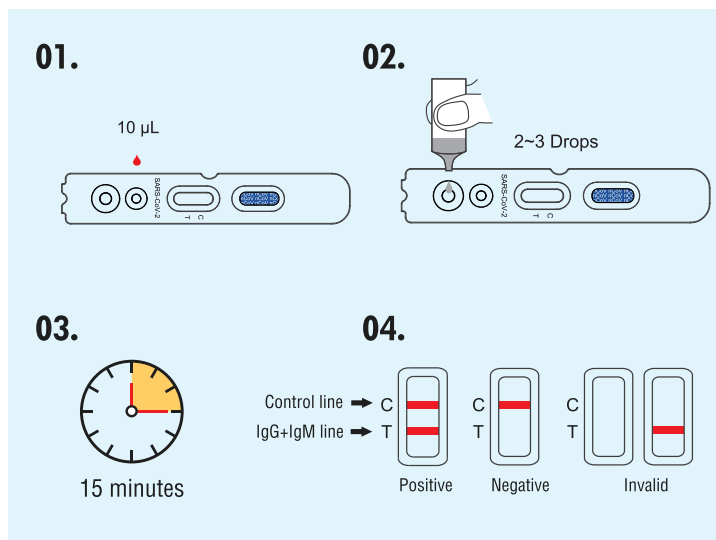

Performance

Reagents		Clinical cases		Total
		Confirmed case samples	Excluded case samples	
Wondfo SARS-CoV-2 Antibody Test (Laberal Flow Method)	Positive	312	1	313
	Negative	49	234	283
Total		361	235	596

Sensitivity: 86.43% (95%CI: 82.51%~89.58%)

Specificity: 99.57% (95%CI: 97.63%~99.92%)

Total consistent: 91.61% (95%CI: 89.10%~93.58%)

Order information

Catalog No.	Product name	Packing size	Sample type	Storage condition	Shelf life	Qualification
W195	SARS-CoV-2 Antibody Test (Lateral Flow Method)	20T	Fingerstick blood, venous whole blood plasma, serum	2~30°C	12 months	CFDA, CE

